

INSTALLATION INSTRUCTIONS

107146 A/C-Blower Control Module

This new-design module replaces GM 25500218 module and can also be used on the Riviera to replace part number 25508453 with minor modification of the mounting plate. **The Caspers design incorporates a separate power feeder which overcomes the typical failure associated with the factory design.** This failure involves one of the terminals on the five pin connector which feeds the module with battery power. When the failure occurs, the terminal overheats and burns the connector and/or connection on the module. Also, since the factory harness connector plugs into the module at a horizontal plane, the connection tends to pick up and hold water and moisture, adding to the corrosion of the electrical connection. The Caspers design overcomes this problem by remotely locating the connector on a short pigtail.

Replacement of this module is simple. Working under the hood at the heater box, unplug both of the connectors to the module. Inspect these connectors for excessive corrosion and clean the terminals with a small brush. Since the replacement module wiring will be routed differently, don't be too concerned about the red wire in terminal E of the original connector; this is commonly the problem wire and will not be used on the new design module.

Using a 9/32" nut driver, remove the two mounting screws that secure the original module to the heater box housing. Lift and twist the module out of its location. Insert the new module, being careful not to bend the heat sinks on the PC board. Replace the two mounting screws.



BE SURE to clean the corrosion off of the connectors with a wire brush and scraper.



Plug both connectors into the factory wiring connectors. Then, route the battery feeder wire to the battery, against the passenger fender well, behind the coolant overflow bottle, and to the **positive** battery post. Remove the positive battery bolt using a 3/8" wrench and press the factory bolt out of the connector lug (see illustration below). Do not use excessive force when tightening the bolt as you can strip the threads on the battery.

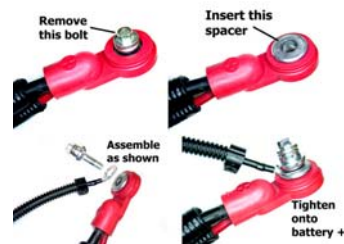

Installs on Blower Housing

